

Designed for the future.



Architectural Sound Design.

www.fohn.com



Sound . Innovation . Design .

Contents

Philosophy	3
Fullrange- / Mid-High systems	8 - 27
Subwoofer systems	28
Directional speaker systems	30
Weather proof speaker systems (plastic housings)	32
VarioTube coaxial speaker systems - in-ceiling and wall mount version	34
- free hanging version	36
References	38
Technical specifications overview	43



Designed for the future.

ARC – Architectural Sound Design – meets demands for maximum acoustic quality and stylish design. ARC is a successful combination of practicality and elegance.

With our new ARC speaker systems, we offer media planners, architects and designers versatile acoustic and visual design options for creative planning.

Optimal sound reproduction is the art of creating audible free space by designing room layouts in line with the user's audio requirements. With the ARC speaker systems, planning support and advice, we offer our customers a comprehensive service by assisting with the implementation of the most diverse sound requirements.

We have quality awareness for materials and material-processing methods, realise visions in the form of new products and combine the desirable with the feasible. In principle, design processes are thinking processes. They are constantly recreated through flexibility, teamwork, curiosity and enthusiasm. This applies just as much for the acoustics as for the appearance and design, where the listener is always the central focus. We continually strive to make complex sound technology as easy as possible for the user.



A handwritten signature in black ink, appearing to read 'H. Barth'.

Helmut Barth
*Executive board,
research & development*

A handwritten signature in black ink, appearing to read 'Jochen Schwarz'.

Dipl.-Ing.
Jochen Schwarz
*Executive board,
organization & finance*

A handwritten signature in black ink, appearing to read 'Uli Haug'.

Dipl.-Medien P.
Uli Haug
*Executive board,
marketing & distribution*

Enduring quality and safety – for you and your customers

Our quality workmanship has only one claim: Perfection. We are only satisfied when all components are correctly in place and each individual screw is sitting snugly. A combination of state-of-the-art CNC production, perfect handwork and our passionate affiliation to the product are simply irreplaceable. We do not manufacture low-cost or mass-produced goods, but exclusive, extremely durable products that are designed and built to last.

We are very meticulous when it comes to material selection. Our ARC speaker housings are manufactured from quality multiply birch wood and the compact housings from the Boardroom series are made from high-quality MDF to produce a piano-surface finish. The outstanding mechanical and acoustic properties of both materials make them perfect for housing manufacture. The manufacturing process involves complex assembly procedures to join, glue and screw the housings together - the housing walls are then reinforced on the inside with aluminium brackets. M6/M8 threaded inserts are integrated in the top, bottom, sides and back of the housing to ensure quick, secure attachment of wall brackets, retaining brackets or ring lugs (for extra safety). The safety equipment that accompanies ARC systems allows you to install the speakers correctly in accordance with all legal regulations.

Extensive measuring and assurance procedures guarantee the consistent high quality standard of our products. Our highly motivated and trained staff carry out strict electronic, acoustic and visual quality checks on each individual speaker. This is also one of the reasons why customers, specialist retailers and trading partners worldwide hold our manufacturing quality in equally high regard.



Colours that set the right tone

With the right colour, even the most beautiful structure is able to enhance its individuality more vividly. When selecting a colour for your speakers, the possibilities are virtually unlimited and whatever your colour preferences may be, we offer the full range of RAL colours. Paints are always applied with the utmost care so that you can appreciate the elegance of your speakers for many years to come. The elegant piano surface finish on the exclusive models in the ARC Boardroom series glows with radiance. The surface consists of ten layers applied individually, sanded several times and then very carefully polished by hand to achieve a classic glossy finish. The painted piano surface is available in black and silver, and epitomises finishing of the highest quality – in combination with chrome-plated or golden decorative strips, it adopts a timeless elegant, attractive design.





Reliable, even when subjected to harsh weather conditions

Models in the ARC series can be supplied with a special plastic weatherproof surface finish or in a complete weatherproof VSM housing, if required. The speakers are also impregnated, and weather-resistant foam is integrated in the front to protect effectively against moisture and dust. Our all-round talent, the AT-21w, which comes fitted with a complete plastic housing ex works, has demonstrated its outstanding quality for years in stadiums, open-air theatres and at numerous other venues.

Well-equipped for the future

Should you wish to upgrade your speaker system in the future, all components in the ARC series are easily upgradable because all models can be combined with one another both acoustically and visually, irrespective of their size. Since all our speakers are developed and manufactured in line with the same principles, each additional component is already perfectly adapted to your design concept.

Perfect sound reproduction thanks to state-of-the-art development and measuring techniques

We attach great importance to modern, computer-assisted simulation and measuring techniques. The linear frequency response, even sound characteristics, accurate reproduction of the signal shape (minimum phase design) and controlled dispersion are optimised as standard on all speakers. A Fohhn speaker is subject to extensive measuring and test procedures, from the development phase right through to the final inspection. Each speaker therefore becomes a tool that you can use to plan and calculate, and which reproduces previously simulated results in practice. We would be happy to make any data files for our speaker systems available to planning engineers and installation companies.



Special requirements? We are all ears

Whether the perfect speaker system for the McLaren presentation centre in England, the right surround system for a rollercoaster at a theme park or the acoustic system in the research laboratory for Mercedes Benz commercial vehicles, special developments devised in close collaboration with our customers always provide the right solution for your specific requirements.

Service guaranteed

Fohhn speaker systems are extremely reliable and require minimal servicing. We therefore offer you a full 3-year warranty on speaker products from the ARC series. Should your speaker require servicing, we will endeavour to deliver replacement parts quickly and unambiguously within 48 hours anywhere in Europe.

Clear contours – clear design

Simplicity is always an art. Our clear design does not include fancy details. Precisely calculated, statistic-based dimensions not only generate a particularly robust design, but are also deemed extremely attractive to the human eye. This is why a timeless linear shape is a central component of our design philosophy.

At your service

It goes without saying that we would be glad to answer any questions you have on how to obtain maximum sound quality. All Fohhn partners receive comprehensive consultation and support in project planning, if required. As far as selecting the correct speakers is concerned, we will always provide you with the necessary assistance, such as arranging simulations for both your small and large-scale sound projects.

Quality through qualification

Because the development of our own knowledge is just as important to us as permanent qualification of our customers, we consider any form of advanced training as an investment in the future. Fohhn holds regular workshops where you can find all the relevant answers to questions you have on topics such as acoustics, measuring techniques or acoustic simulation. Our staff regularly take part in comprehensive workshops for further training because they like to stay on the ball - high quality and quality assurance at Fohhn are by no means coincidence.



AT-05

The Fohhn® AT-05 is an extremely elegant compact wooden speaker system that produces outstanding sound. The attractive design of the speakers provides a real alternative to standard plastic speakers.

Technical specifications

Principle	2 way, vented
Power rating (AES/Progr.)	80 W / 120 W
Components	1 x 5" / 1" short horn, time-aligned
Sensitivity	88 dB
SPL max.	108 dB
Frequency response (-10 dB)	60 Hz - 20 kHz
Frequency response (-3 dB)	80 Hz - 19 kHz
Dispersion (HxV)	90° x 90°
Impedance	8 ohm
Dimensions (WxHxD)	16.5 x 28.5 x 20 cm
Weight approx.	4.5 kg
100V version (optional)	25 W
Housing	MDF
Colour	black, white
Optional colours	all RAL-colours
Frontdesign	acoustic transparent foam
Protective grille	metal
Connectors	terminals



Description

Fitted with excellent speaker components and available in all RAL colours, the AT-05 is a real work of art for high-quality speech and music reproduction. Versatile wall brackets and M6 threaded inserts allow quick, safe installation. A top-quality crossover with electronic high-frequency protection circuit is also integrated. Ideal in combination with the AS-05 bass system.

Applications

Pubs, bars, restaurants, small training rooms, close-range sound and surround sound applications.



Piano finish version (optional)

- Also available in high-gloss piano finish, black and silver. Decor strip chrome or gold.



WAT-05 wall bracket (optional)
available in all RAL colours

WAT-05 wall mount bracket, universal
adjustment with swivel joint



WAT-06 stylish bracket, swivel joint,
tiltable ($\pm 25^\circ$), glass fibre



VAT-09 Ceiling mount bracket, horizontal
and vertical adjustment ($360^\circ/\pm 25^\circ$), metal

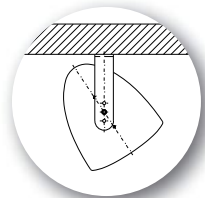

QAT-05 Horizontal bracket, metal



Vorderansicht / Front view Seitenansicht / Side view Rückansicht / Rear view

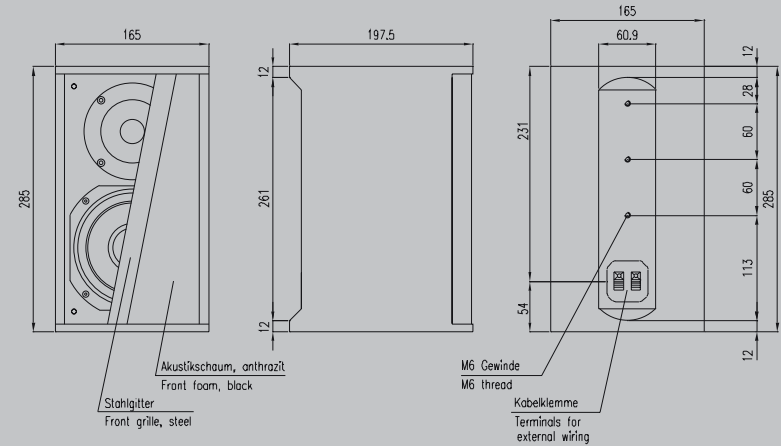

Draufsicht / Top view

Bodensicht / Bottom view

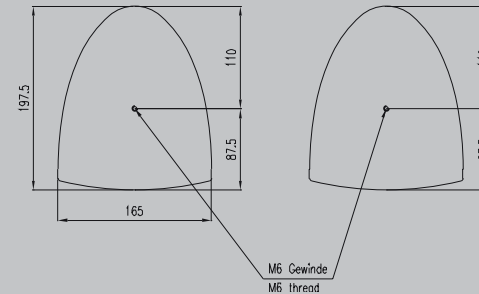

AT-06

Modern design, compact dimensions and excellent fullrange sound characterize the Fohhn® AT-06. It is designed for high-quality speech and music transmission in small conference rooms, AV and surround applications.

Technical specifications

Principle	2 way, vented
Power rating (AES/Progr.)	100 W / 200 W
Components	6"/1" short horn, time-aligned
Sensitivity	90 dB
SPL max.	113 dB
Frequency response (-10 dB)	45 Hz - 20 kHz
Frequency response (-3 dB)	60 Hz - 20 kHz
Dispersion (HxV)	90° x 90°
Impedance	8 ohm
Dimensions (WxHxD)	19.5 x 38 x 23 cm
Weight approx.	5.5 kg
100V version (optional)	60 W / 120 W
Housing	Multiply birchwood
Colour	black, white
Optional colours	all RAL-colours
Frontdesign	acoustic transparent foam
Protective grille	metal
Connectors	Speakon + 4-point terminal plug (inside)



Description

A new wood-processing technique produces the round, flowing shape of this exclusive 6"/1" speaker. The AT-06 is available in all RAL colours and blends effortlessly into its surroundings. TÜV-certified wall brackets and 8 x M6 threaded inserts ensure quick and secure installation. Integral crossover with electronic tweeter protection. Can be combined with subwoofers AS-05 and XSP-2.

Applications

Training rooms, 5.1 Surround applications, Bars, Clubs, Installation under balconies or galleries, Near-field sound transmission.



Weatherproof version (optional)

- Wooden Housing, special weatherproof plastic coating, impregnated speakers, design and dimensions unchanged

Piano finish version (optional)

- Also available in high-gloss piano finish, black and silver. Decor strip chrome or gold.



WAT-08 Metal-bracket, swivel joint,
available in all RAL colours
universal adjustment



WAT-09 stylish bracket, swivel joint,
tiltable ($\pm 25^\circ$), metal



VAT-09 Ceiling mount bracket, horizontal
and vertical adjustment ($360^\circ/\pm 25^\circ$), metal

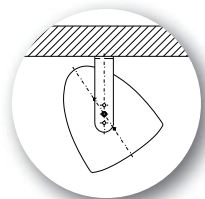

QAT-07 Horizontal bracket, metal

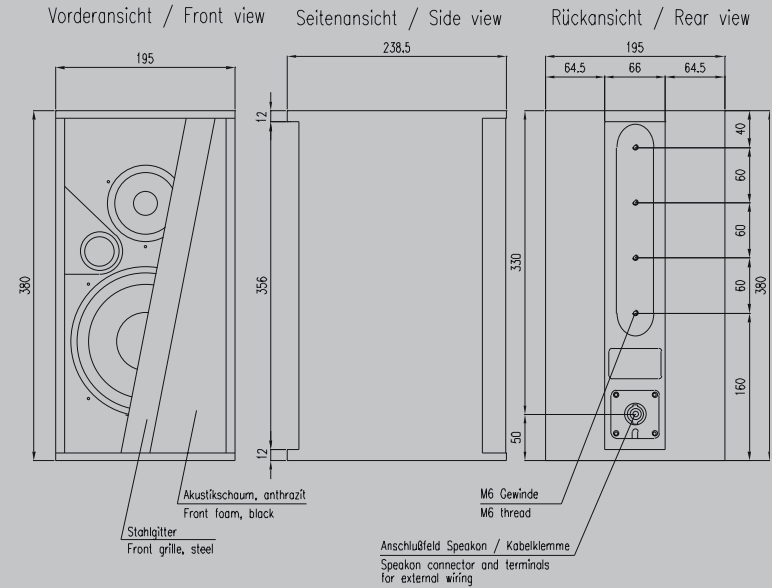

Draufsicht / Top view Bodensicht / Bottom view

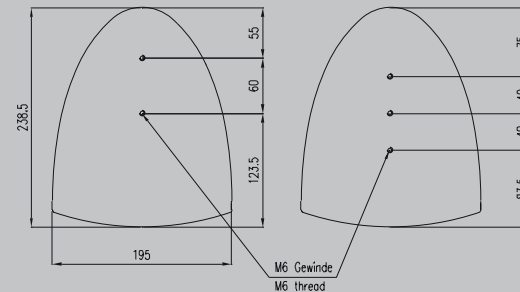

AT-07

The Fohhn® AT-07 impresses with its high performance capacity within such compact dimensions and extremely attractive design. It is designed for applications that require high acoustic output, but for aesthetic reasons, only allow compact dimensions.

Technical specifications

Principle	2 way, vented
Power rating (AES/Progr.)	150 W / 300 W
Components	6.5"/1" CD/time-aligned
Sensitivity	96 dB
SPL max.	123 dB
Frequency response (-10 dB)	65 Hz - 20 kHz
Frequency response (-3 dB)	85 Hz - 20 kHz
Dispersion (HxV)	90° x 60°
Impedance	16 ohm
Dimensions (WxHxD)	19.5 x 38 x 23 cm
Weight approx.	7.3 kg
100V version (optional)	60 W / 120 W
Housing	Multiply birchwood
Colour	black, white
Optional colours	all RAL-colours
Frontdesign	acoustic transparent foam
Protective grille	metal
Connectors	Speakon + 4-point terminal plug (inside)



Description

The extremely high-quality speaker configuration with 6.5" bass-mid speaker and 1" compression driver with constant directivity horn guarantees outstanding speech intelligibility. The elegant wooden housing is available in all RAL colours.

TÜV-certified wall brackets and 8 x M6 threaded inserts ensure quick and secure installation. Integral crossover with electronic high frequency protection. Can be combined with subwoofer XSP-2.

Applications

Conference- and training rooms, 5.1 Surround applications, Clubs, Installation under balconies or galleries, Near-field sound transmission.



Weatherproof version (optional)

- Wooden Housing, special weatherproof plastic coating, impregnated speakers, design and dimensions unchanged

Piano finish version (optional)

- Also available in high-gloss piano finish, black and silver. Decor strip chrome or gold.



WAT-08 Metal-bracket, swivel joint,
available in all RAL colours

WAT-08 Metal-bracket, swivel joint,
universal adjustment



WAT-09 stylish bracket, swivel joint,
tiltable ($\pm 25^\circ$), metal



VAT-09 Ceiling mount bracket, horizontal
and vertical adjustment ($360^\circ/\pm 25^\circ$), metal

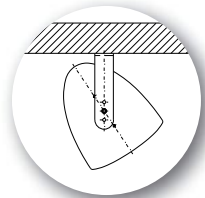

QAT-07 Horizontal bracket, metal

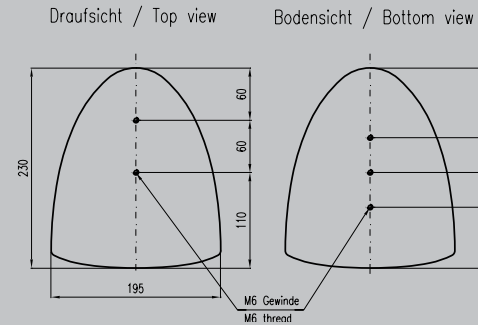
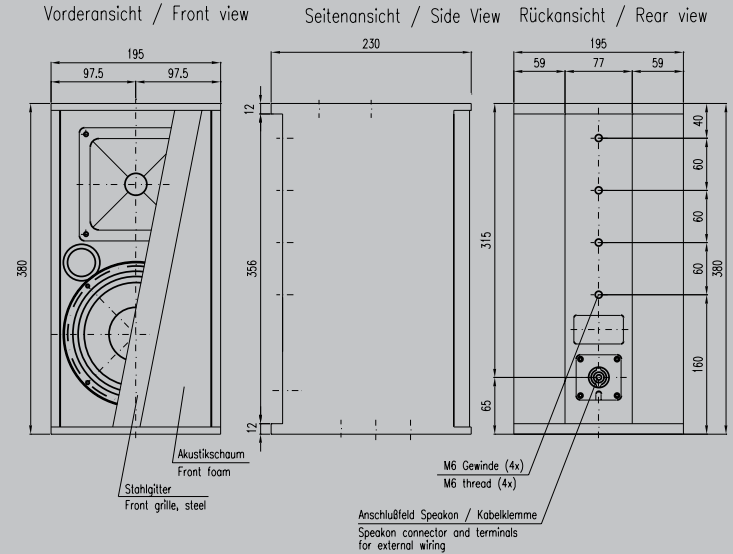

AT-08

Fohhn® AT-08 is the reliable formula for an stylish two-way speaker system with an equally elegant rounded wooden housing. The AT-08 is designed for short to medium distances and near-field at larger venues.

Technical specifications

Principle	2 way, closed
Power rating (AES/Progr.)	150 W / 300 W
Components	2 x 6" / 1" short horn, time-aligned
Sensitivity	95 dB
SPL max.	119 dB
Frequency response (-10 dB)	50 Hz - 20 kHz
Frequency response (-3 dB)	65 Hz - 20 kHz
Dispersion (HxV)	90° x 40°
Impedance	8 ohm
Dimensions (WxHxD)	19.5 x 51 x 23 cm
Weight approx.	7 kg
100V version (optional)	60 W / 120 W
Housing	Multiply birchwood
Colour	black, white
Optional colours	all RAL-colours
Frontdesign	acoustic transparent foam
Protective grille	metal
Connectors	Speakon + 4-point terminal plug (inside)



Description

Phase-optimized with two 6" cone speakers and 1" spherical horn in d'Apollito arrangement guarantees even sound dispersion. A precision-made crossover with electronic high-frequency protection circuit is also included. 10 M6 threaded inserts guarantee safe speaker installation in accordance with all current regulations. The AT-08 is ideal both as a fullrange and mid-high system in combination with subwoofer systems AS-20/ASP-20 and AS-30.

Applications

Conference and training rooms, hotels, clubs, theatres, churches, multimedia presentations, horizontal assembly under balconies and galleries, surround sound applications.



Weatherproof version (optional)

- Wooden Housing, special weatherproof plastic coating, impregnated speakers, design and dimensions unchanged.



Wall bracket (optional)
available in all RAL colours

WAT-08 Metal-bracket, swivel joint,
universal adjustment



WAT-09 stylish bracket, swivel joint,
tiltable ($\pm 25^\circ$), metal



VAT-09 Ceiling mount bracket, horizontal
and vertical adjustment ($360^\circ/\pm 25^\circ$), metal

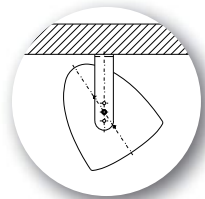

QAT-09 Horizontal bracket, metal



• **WAT-12** Versatile bracket,
horizontal and vertical adjustment ($120^\circ/45^\circ$)

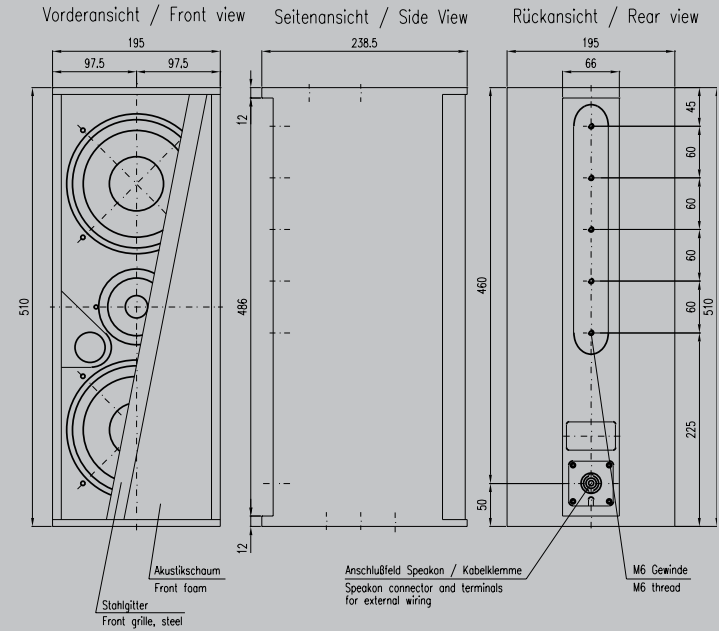

Draufsicht / Top view

Bodensicht / Bottom view

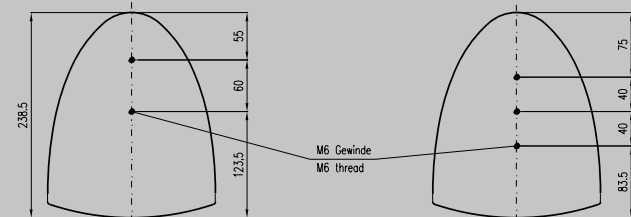

AT-09

The well-designed Fohhn® AT-09 is essential for all applications requiring maximum acoustic efficiency and extremely compact speaker dimensions. Outstanding speech intelligibility combined with excellent dispersion characteristics make the AT-09 the ultimate all-rounder.

Technical specifications

Principle	2 way, closed
Power rating (AES/Progr.)	200 W / 400 W
Components	2 x 6.5"/1" CD, time-aligned
Sensitivity	98 dB
SPL max.	125 dB
Frequency response (-10 dB)	65 Hz - 20 kHz
Frequency response (-3 dB)	75 Hz - 20 kHz
Dispersion (HxV)	90° x 60°
Impedance	8 ohm
Dimensions (WxHxD)	19.5 x 51 x 23 cm
Weight approx.	10.5 kg
100V version (optional)	60 W / 120 W
Housing	Multiply birchwood
Colour	black, white
Optional colours	all RAL-colours
Frontdesign	acoustic transparent foam
Protective grille	metal
Connectors	Speakon + 4-point terminal plug (inside)



Description

The AT-09 is fitted with an exclusive 2x 6.5"/1" CD speaker in d'Apollito arrangement. The CD horn can be rotated 90°. A precision-made crossover with electronic high-frequency protection circuit and auto-subsonic shift filter is also integrated. 10 M6 threaded inserts guarantee safe speaker and bracket installation in accordance with all current regulations. The AT-09 can be used as a fullrange or mid-high system in combination with Fohhn subwoofer systems AS-20/ASP-20, AS-30/ASP-30 and AS-40.

Applications

Conference and training rooms, halls, hotels, clubs, theatres, churches, multimedia presentations, horizontal assembly under balconies and galleries.



Weatherproof version (optional)

- Wooden Housing, special weatherproof plastic coating, impregnated speakers, design and dimensions unchanged.



Wall bracket (optional)
available in all RAL colours

WAT-09 stylish bracket, swivel joint,
tiltable ($\pm 25^\circ$), metal



VAT-09 Ceiling mount bracket, horizontal
and vertical adjustment ($360^\circ/\pm 25^\circ$), metal



WAT-12 versatile bracket, horizontal and
vertical adjustment ($120^\circ/45^\circ$)

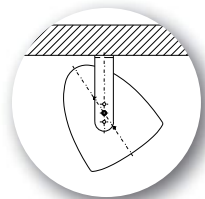

QAT-09 Horizontal bracket, metal

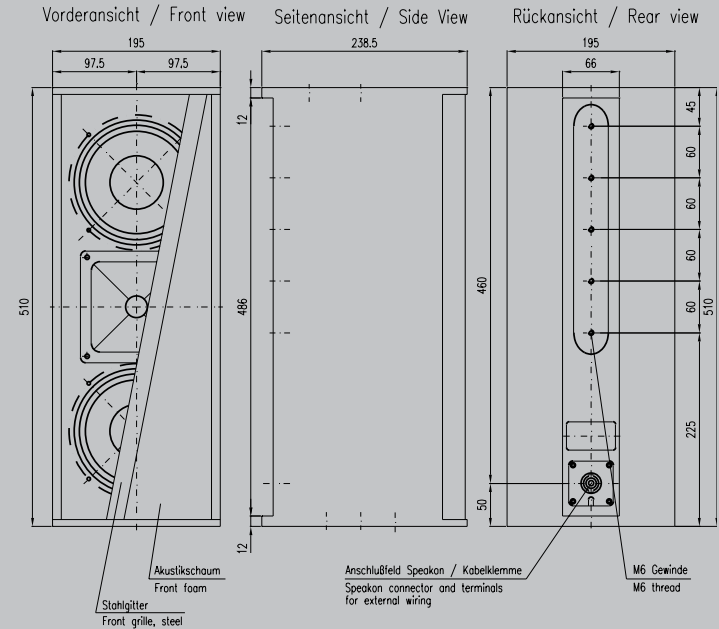

Draufsicht / Top view

Bodensicht / Bottom view

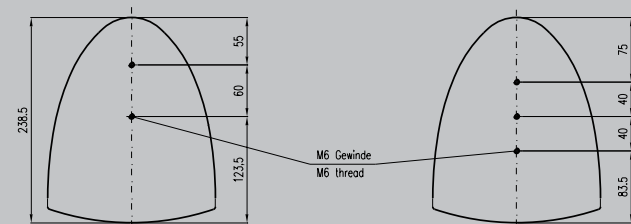

AT-20

The Fohhn® AT-20 is both a sound and flexibility specialist. Extremely effective with compact dimensions, it can be used as a main sound system in locations with a complex architectural layout to replace large speakers.

Technical specifications

Principle	2 way, vented
Power rating (AES/Progr.)	300 W / 600 W
Components	10" / 1" CD, time-aligned
Sensitivity	101 dB
SPL max.	129 dB
Frequency response (-10 dB)	65 Hz - 20 kHz
Frequency response (-3 dB)	75 Hz - 20 kHz
Dispersion (HxV)	60°x40° / 90°x40° / 90°x60°
Impedance	8 ohm
Dimensions (WxHxD)	33 x 51 x 30 cm
Weight approx.	15,5 kg
100V version (optional)	120 W / 240 W
Housing	Multiply birchwood
Colour	black, white
Optional colours	all RAL-colours
Frontdesign	acoustic transparent foam
Protective grille	metal
Connectors	Speakon + 4-point terminal plug (inside)



Description

This versatile, well-designed two-way speakersystem includes a power-ful 10" cone speaker and a high-quality 1" driver. The CD horn developed by Fohhn can be rotated 90°. The speakers are time-aligned and guarantee phase-optimized sound dispersion. A crossover with electronic high-frequency protection circuit is also integrated. The wooden housing is reinforced on the inside with aluminium brackets. 11 M8 threaded inserts guarantee safe speaker and bracket installation in accordance with all current regulations. The AT-20 can be combined with subwoofers AS-20/ASP-20, AS-30/ASP-30 and AS-40.

Applications

Conference and training rooms, sport and multi-functional halls, theatres, musicals, theme parks, discos, small stadiums and similar venues.



Weatherproof versions (optional)

- Wooden Housing, special weatherproof plastic coating, impregnated speakers, design and dimensions unchanged
- Extrem weather resistant VSM-housing, outstanding impregnated speakers, design and dimensions unchanged



Wall bracket (optional)
available in all RAL colours

- **WAT-12** Versatile bracket, horizontal and vertical adjustment (120°/45°)
- **VAT-20** Vertical bracket, metal
- **QAT-20** Horizontal bracket, metal

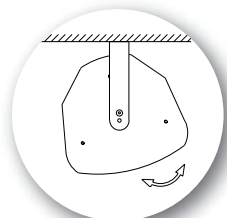
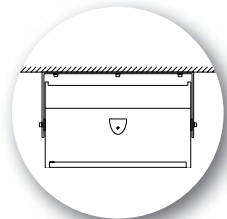
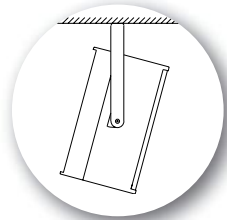

Vorderansicht / Front view

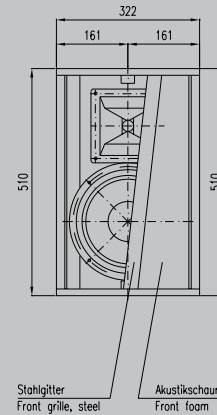

Seitenansicht / Side View

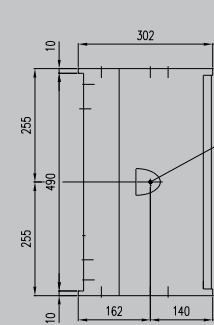

Rückansicht / Rear view

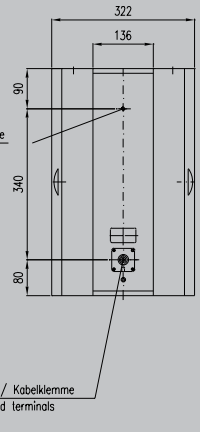

Draufsicht / Top view

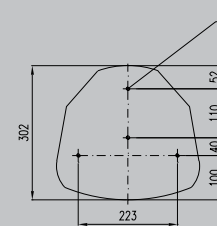

Bodensicht / Bottom view

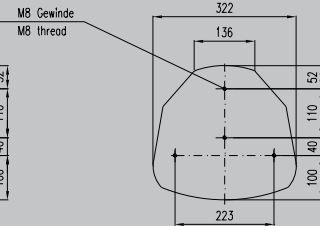



Architectural Sound Design.

AT-30

The Fohhn® AT-30 is one of the most versatile speaker systems in the ARC series. Both powerful and well-designed, it is suitable for the most demanding medium-distance applications.

Technical specifications

Principle	2 way, vented
Power rating (AES/Progr.)	350 W / 700 W
Components	12"/1" CD, time-aligned
Sensitivity	97 dB
SPL max.	127 dB
Frequency response (-10 dB)	55 Hz - 20 kHz
Frequency response (-3 dB)	65 Hz - 20 kHz
Dispersion (HxV)	60° x 40° / 90° x 40° / 90° x 60°
Impedance	8 ohm
Dimensions (WxHxD)	38 x 59 x 42 cm
Weight approx.	20 kg
100V version (optional)	120 W / 240 W
Housing	Multiply birchwood
Colour	black, white
Optional colours	all RAL-colours
Frontdesign	acoustic transparent foam
Protective grille	metal
Connectors	Speakon + 4-point terminal plug (inside)



Description

The AT-30 is a classic 12"/1" speaker system that is perfect for full-range applications. It is fitted with a CD horn that can be rotated 90° and can therefore be used in both vertical and horizontal positions. The speakers are time-aligned and guarantee a defined sound dispersion. A precision-made crossover with electronic high-frequency protection circuit is also integrated. The AT-30 is reinforced on the inside with aluminium brackets and equipped with 11 M8 threaded inserts for safe installation in accordance with all current regulations. It can be combined with subwoofers AS-30/ASP-30 and AS-40.

Applications

Medium-sized sport arenas and multi-functional halls, theatres, musicals, theme parks, discos, clubs and similar venues.



Weatherproof versions (optional)

- Wooden Housing, special weatherproof plastic coating, impregnated speakers, design and dimensions unchanged
- Extrem weather resistant VSM-housing, outstanding impregnated speakers, design and dimensions unchanged

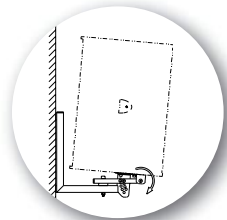

Wall bracket (optional)
available in all RAL colours

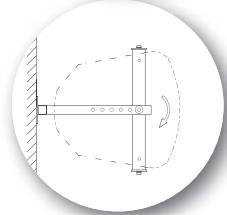

- **WAT-34** Wall bracket, horizontal and vertical adjustment
- **VAT-34** Vertical bracket, metal
- **QAT-34** Horizontal bracket, metal

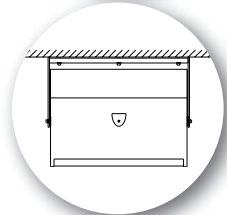
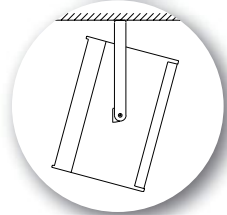
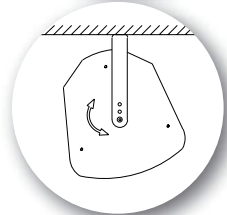

Vorderansicht / Front view Seitenansicht / Side view Rückansicht / Rear view

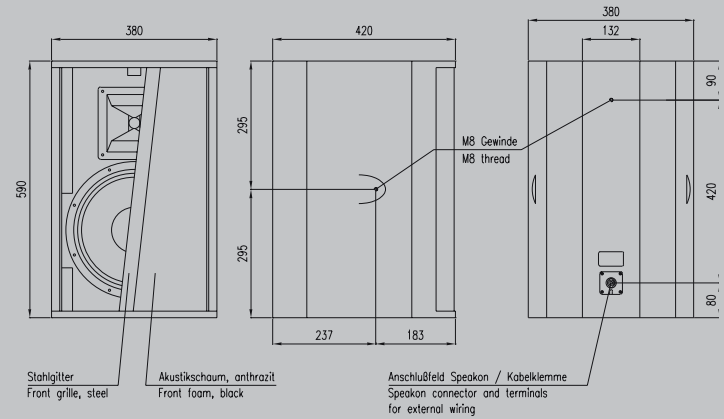

Draufsicht / Top view

Bodensicht / Bottom view

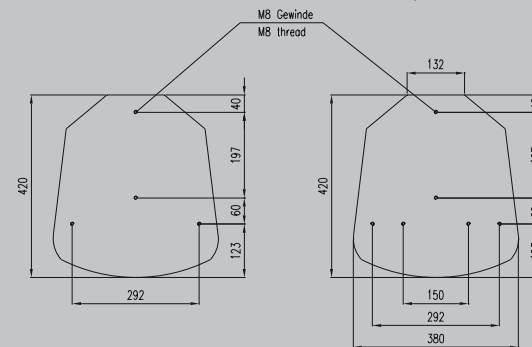

AT-35

The Fohhn® AT-35 is like its smaller brother the AT-30, very versatile and designed for medium distances. It has however, a considerably greater output capacity (500W) and generates a significantly higher sound pressure level.

Technical specifications

Principle	2 way, vented
Power rating (AES/Progr.)	500 W / 900 W
Components	12"/1" CD, neodym, time-aligned
Sensitivity	100 dB
SPL max.	131 dB
Frequency response (-10 dB)	55 Hz - 20 kHz
Frequency response (-3 dB)	65 Hz - 20 kHz
Dispersion (HxV)	60° x 40° / 90° x 40° / 90° x 60°
Impedance	8 ohm
Dimensions (WxHxD)	38 x 59 x 42 cm
Weight approx.	19 kg
100V version (optional)	120 W / 240 W / 360 W
Housing	Multiply birchwood
Colour	black, white
Optional colours	all RAL-colours
Frontdesign	acoustic transparent foam
Protective grille	metal
Connectors	Speakon + 4-point terminal plug (inside)



Description

The AT-35 is equipped with the latest generation of 12"/1" Neodymium speakers. The AT-35 is both very lightweight and extremely powerful thanks to Neodym technology. It can be installed in a vertical or horizontal position and the CD horn can be rotated 90°. The speakers are time-aligned. A precision-made crossover with electronic high-frequency protection circuit is also integrated. The wooden housing is reinforced with aluminium brackets and equipped with 11 M8 threaded inserts for safe installation in accordance with all current regulations. The AT-35 can be combined with subwoofers AS-30/ASP-30 and AS-40.



Applications

Sport halls and arenas, multi-functional halls, theatres, musicals, theme parks, discos, clubs and similar venues.



Weatherproof versions (optional)

- Wooden Housing, special weatherproof plastic coating, impregnated speakers, design and dimensions unchanged
- Extrem weather resistant VSM-housing, outstanding impregnated speakers, design and dimensions unchanged

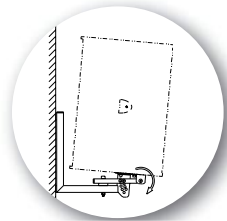

Wall bracket (optional)
available in all RAL colours

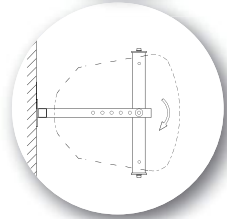

- **WAT-34** Wall bracket, horizontal and vertical adjustment
- **VAT-34** Vertical bracket, metal
- **QAT-34** Horizontal bracket, metal

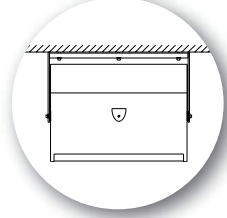
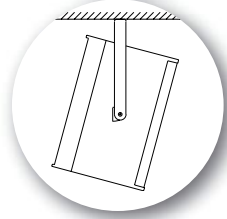
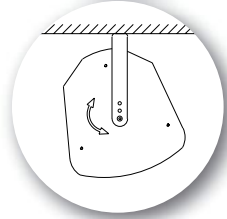

Vorderansicht / Front view Seitenansicht / Side view Rückansicht / Rear view

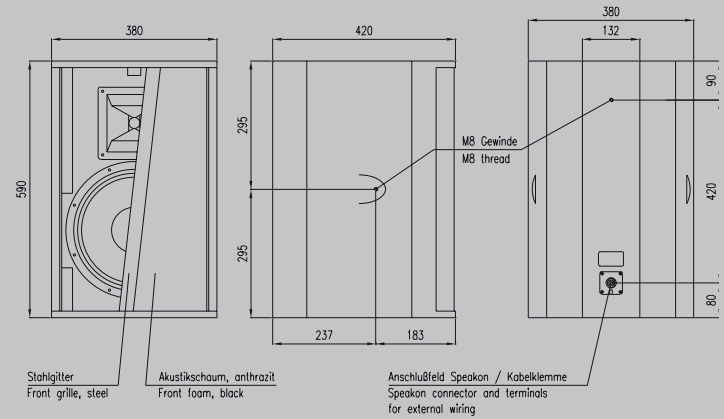

Draufsicht / Top view

Bodensicht / Bottom view

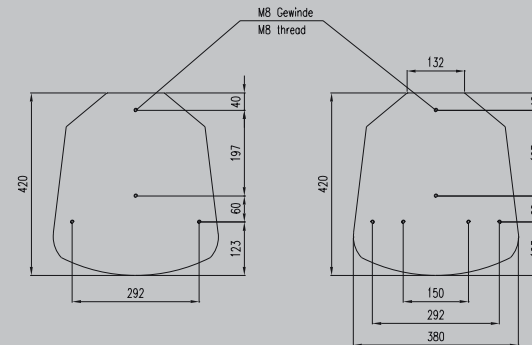

AT-40

The Fohhn® AT-40 is an extremely powerful, high-capacity speaker system in a comparatively compact housing. It combines efficiency, speech intelligibility, sound quality and design at the highest level.

Technical specifications

Principle	2 way, vented
Power rating (AES/Progr.)	500 W / 1000 W
Components	12"/1.4" CD, neodym, time-aligned
Sensitivity	100 dB
SPL max.	134 dB
Frequency response (-10 dB)	50 Hz - 20 kHz
Frequency response (-3 dB)	60 Hz - 20 kHz
Dispersion (HxV)	60° x 40° / 80° x 50°
Impedance	8 ohm
Dimensions (WxHxD)	38 x 59 x 42 cm
Weight approx.	22 kg
100V version (optional)	120 W / 240 W / 360 W
Housing	Multiply birchwood
Colour	black, white
Optional colours	all RAL-colours
Frontdesign	acoustic transparent foam
Protective grille	metal
Connectors	Speakon + 4-point terminal plug (inside)



Description

The AT-40 is equipped with state-of-the-art time-aligned 12"/1.4" Neodymium speakers and is therefore extremely lightweight. It can be fitted with either an 80°x50° or 60°x40° rotating CD horn (HxV), depending on the application. A precision-made crossover with electronic high-frequency protection circuit is also integrated. The AT-40 is reinforced on the inside with aluminium brackets and equipped with 11 M8 threaded inserts for safe installation in accordance with all current regulations. The AT-40 produces a perfect sound when combined with subwoofers AS-30/ASP-30 and AS-40/ASP-40 and operates as a fullrange or mid-high system.

Applications

Sport arenas, multi-functional halls, stadiums, theatres, musicals, theme parks, discos and similar venues.



Weatherproof versions (optional)

- Wooden Housing, special weatherproof plastic coating, impregnated speakers, design and dimensions unchanged
- Extrem weather resistant VSM-housing, outstanding impregnated speakers, design and dimensions unchanged

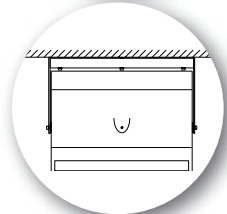
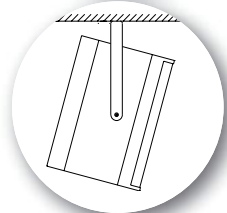
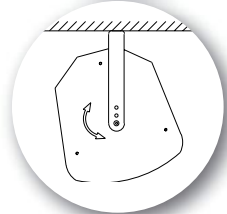
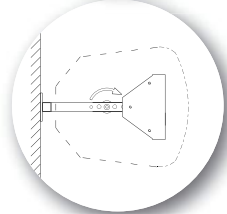
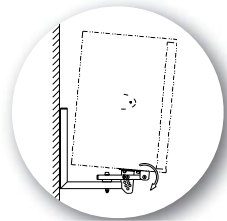

Wall bracket (optional)
available in all RAL colours

- **WAT-34** Wall bracket, horizontal and vertical adjustment
- **VAT-34** Vertical bracket, metal
- **QAT-34** Horizontal bracket, metal

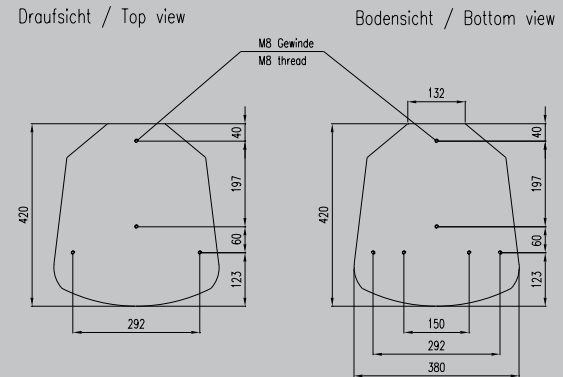
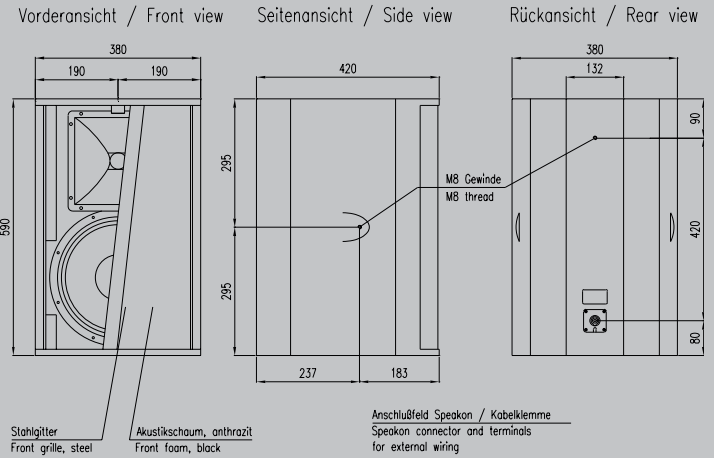

AT-50

The Fohhn® AT-50 is an excellent lightweight fullrange speaker system with high power output. It was developed for high-quality sound applications that require wide-band sound transmission but that cannot incorporate an extra subwoofer system.

Technical specifications

Principle	2 way, vented
Power rating (AES/Progr.)	500 W / 1000 W
Components	15"/1.4" CD, neodym, time-aligned
Sensitivity	100 dB
SPL max.	134 dB
Frequency response (-10 dB)	45 Hz - 20 kHz
Frequency response (-3 dB)	55 Hz - 20 kHz
Dispersion (HxV)	60° x 40° / 80° x 50°
Impedance	8 ohm
Dimensions (WxHxD)	46 x 68 x 46.5 cm
Weight approx.	28 kg
100V version (optional)	120 W / 240 W / 360 W
Housing	Multiply birchwood
Colour	black, white
Optional colours	all RAL-colours
Frontdesign	acoustic transparent foam
Protective grille	metal
Connectors	Speakon + 4-point terminal plug (inside)



Description

Fully equipped with state-of-the-art 15"/1.4" CD Neodym speakers, the AT-50 produces outstanding sound results. The large constant-directivity horn is rotatable and available in two versions, 80°x50° or 60°x40° (HxV). The housing is reinforced with aluminium brackets. A total of 11 M8 threaded inserts guarantee safe installation in accordance with all current regulations. A high-quality crossover with electronic high-frequency protection circuit is also integrated. Ideal in combination with subwoofer systems AS-30/ ASP-30 and AS-40/ASP-40.

Applications

Large sport and multi-functional halls, stadiums, musicals, theatres, theme parks, discos and similar applications.



Weatherproof versions (optional)

- Wooden Housing, special weatherproof plastic coating, impregnated speakers, design and dimensions unchanged
- Extrem weather resistant VSM-housing, outstanding impregnated speakers, design and dimensions unchanged

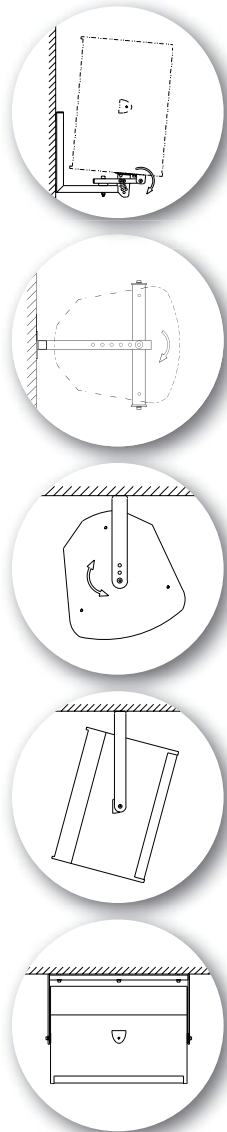

Wall bracket (optional)
available in all RAL colours

- **WAT-50** Wall bracket, horizontal and vertical adjustment
- **VAT-50** Vertical bracket, metal
- **QAT-50** Horizontal bracket, metal



Vorderansicht / Front view

Seitenansicht / Side view

Rückansicht / Rear view

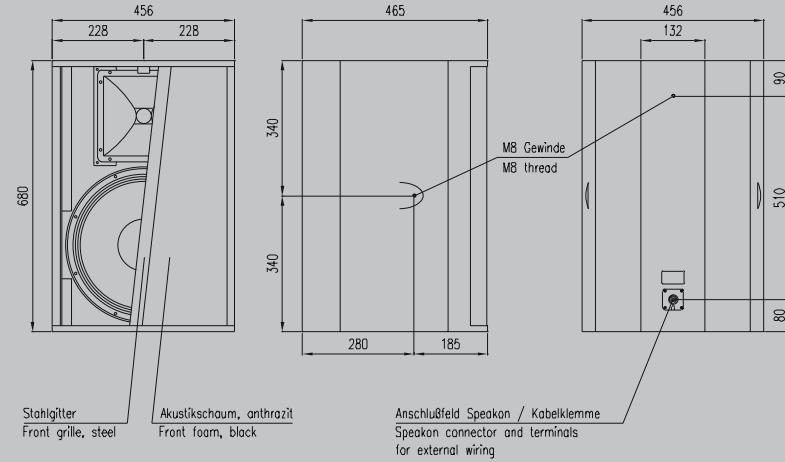

Draufsicht / Top view

Bodensicht / Bottom view

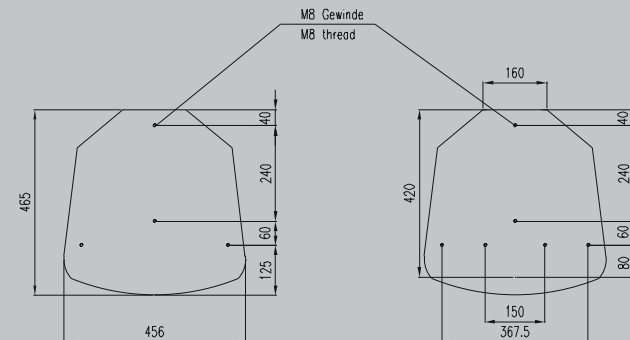



Architectural Sound Design.

Subwoofer Systems

Fohhn® bass systems are characterised by their clear, powerful reproduction of bass frequencies. All models are fitted with top-quality speakers. The compact housings are made from high-quality multiplex birch wood, have integral M8-threaded inserts and are available in all RAL colours.

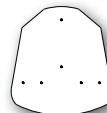
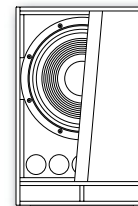
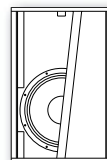
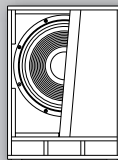
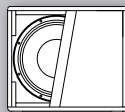

AS-05 / ASP-05

Compact bass system, 200 W, 1x8".
Optionally available with passive crossover (130 Hz/12dB/oct.) as ASP-05.

AS-20 / ASP-20

Compact bass system, 400 W, 1x12".
Optionally available with passive crossover (130 Hz/12dB/oct.) as ASP-20.

AS-30 / ASP-30

Compact high-power bass system, 700 W, 1x15".
Optionally available with passive crossover (130 Hz/12dB oct.) as ASP-30.

AST-30 / ASTP-30

Compact bass system, 400 W, 1x12".
For cluster applications with AT-30/AT-35/AT40.
Optionally available with passive crossover (130 Hz/12dB/oct.) as ASTP-30.

AS-40 / ASP-40

Compact high-power bass system, 800 W, 1x18".
Optionally available with passive crossover (130 Hz/12dB/oct.) as ASP-40.

Technical specifications	AS-05 / ASP-05	AS-20 / ASP-20	AS-30 / ASP-30	AST-30 / ASTP-30	AS-40 / ASP-40
Principle	Bandpass design	vented design	direct transmission/backloaded res.	vented design	direct transmission/backloaded res.
Power rating (AES/Progr.)	200 W / 400 W	400 W / 600 W	700 W / 1000 W	400 W / 600 W	800 W / 1200 W
Components	1 x 8"	1 x 12"	1 x 15"	1 x 12"	1 x 18"
Sensitivity	90 dB	97 dB	98 dB	97 dB	99 dB
SPL max.	117dB	125 dB	128 dB	126 dB	132 dB
Frequency response (-10dB)	40 Hz - 150 Hz	38 Hz - 500 Hz	40 Hz - 500 Hz	40 Hz - 500 Hz	35 Hz - 500 Hz
Frequency response (-3dB)	50 Hz - 150 Hz	50 Hz - 500 Hz	50 Hz - 500 Hz	50 Hz - 500 Hz	45 Hz - 500 Hz
Impedance	8 Ohm	4 Ohm	8 Ohm	4 Ohm	8 Ohm
Dimensions (WxHxD)	27 x 34,5 x 45cm	43 x 39 x 44 cm	43 x 59 x 52 cm	38 x 59 x 42 cm	51 x 77,5 x 61 cm
Weight approx.	11 kg	19 kg	30 kg	21 kg	40 kg
Housing	multiply birchwood	multiply birchwood	multiply birchwood	multiply birchwood	multiply birchwood
Standard colour	black	black	black	black/white	black
Optional colours	all RAL colours	all RAL colours	all RAL colours	all RAL colours	all RAL colours
Frontdesign	-	acoustic foam	acoustic foam	acoustic foam	acoustic foam
Protective grille	-	metal	metal	metal	metal
Threaded inserts	-	2 x M8 for flying appl	2 x M8 for flying appl	11 x M8 for flying appl.	2 x M8 for flying appl.
Connectors	Speakon/ terminals (ASP-05)	Speakon	Speakon	Speakon	Speakon

AS-05 / ASP-05

Vorderansicht / Front view

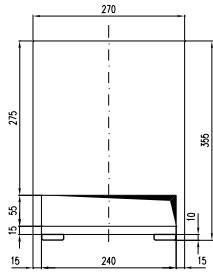

Bodensicht / Bottom view

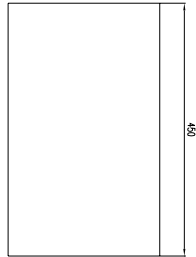

Rückansicht / Rear view

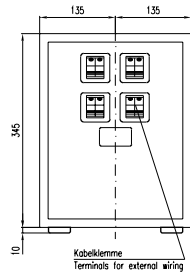

AS-20 / ASP-20

Vorderansicht / Front view

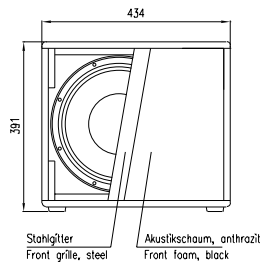

Draufsicht / Top view

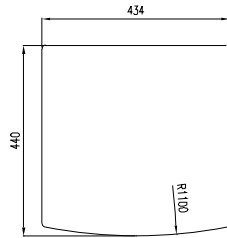

Rückansicht / Rear view

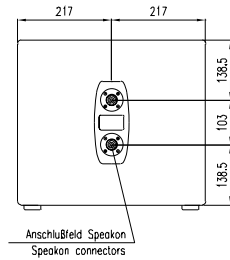

AS-30 / ASP-30

Vorderansicht / Front view

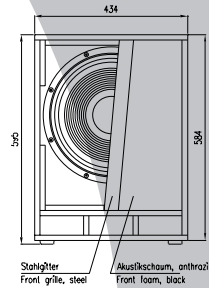

Draufsicht / Top view

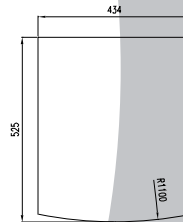

Rückansicht / Rear view

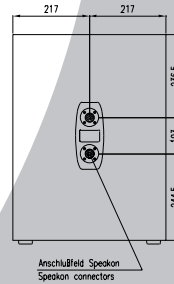

AST-30 / ASTP-30

Vorderansicht / Front view

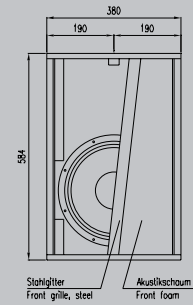

Draufsicht / Top view

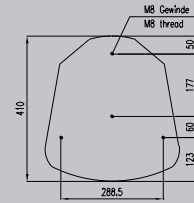

Rückansicht / Rear view

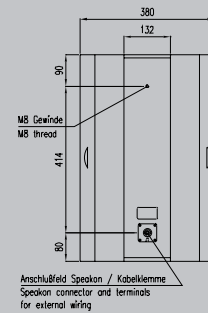

AS-40 / ASP-40

Vorderansicht / Front view

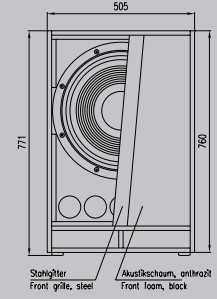

Draufsicht / Top view

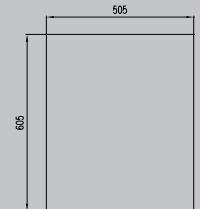

Rückansicht / Rear view

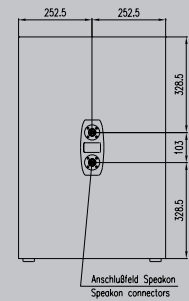

Directional speakers

Special directional speaker systems with cardioid dispersion characteristics

Fohhn® FN-3/FTS-3/FTS-4 – problem solvers for extreme acoustic environments

Problem solvers for extreme acoustic environments with long reverberation times e.g. in churches, museums or halls. All three directional speaker systems achieve considerably better speech intelligibility and sound compared to conventional compact speakers or sound columns – especially if the acoustics are poor. The integral sound compensation system generates frequency-constant directivity, where the speakers aim the sound more specifically at the listeners, who in turn hear the sound much more directly.



Technical specifications	FN-3	FTS-3	FTS-4
	Directional speaker system with cardioid sound characteristics. Exceptionally compact.	Directional column speaker system with cardioid sound characteristics.	Directional column speaker system with cardioid sound characteristics.
Principle	2-way, self contained	2-way, self contained	2-way, self contained
Power rating (AES/Progr.)	50 W / 75 W	80W / 120 W	120W / 200 W
Components	4"/HT	4 x 4"/HTcoax	4 x 6.5"/1" CD, time-aligned
Sensitivity	90 dB	94 dB	97 dB
SPL max.	105 dB	112 dB	120 dB
Frequency response (-10dB)	110 Hz - 20 kHz	90 Hz - 20 kHz	60 Hz - 20 kHz
Frequency response (-3dB)	150 Hz - 18 kHz	110 Hz - 19 kHz	70 Hz - 20 kHz
Dispersion (HxV)	80° x 80° cardioid	100° x 30° cardioid	60° x 40° cardioid
180° attenuation	15 dB (200Hz-20kHz)	15 dB (200Hz - 20kHz)	25 dB (70Hz - 20 kHz)
Impedance	8 ohm	4 ohm	4 ohm
Dimensions (WxHxD)	15 x 15 x 16 cm	15 x 60 x 14 cm	21 x 95,5 x 22 cm
Weight approx.	2.2 kg	6 kg	20 kg
100V version (optional)	25 W	60 W	120W
Housing	Multiply birchwood	Multiply birchwood	Multiply birchwood
Colour	black, white	black, white	black, white
Optional colours	all RAL-colours	all RAL-colours	all RAL-colours
Protective grille	metal	metal	metal
Connectors	terminals	Speakon / 4-point terminal	Speakon / 4-point terminal



Wall bracket (optional)
available in all RAL colours

FN-3

- **WAT-05** wall mount bracket, universal adjustment with swivel joint
- **WAT-06** stylish bracket, swivel joint, tiltable (+/- 25°), glass fibre
- **QN-3** Horizontal bracket, metal

FTS-3

- **WAT-08** Metal-bracket, swivel joint, universal adjustment
- **WAT-09** Stylish bracket, swivel joint, tiltable (+/- 25°), metal
- **QTS-3** Metal-bracket for horizontal or vertical use

FTS-4

- **WAT-12** versatile bracket, horizontal and vertical adjustment (120°/45°)



FN-3

Vorderansicht / Front view

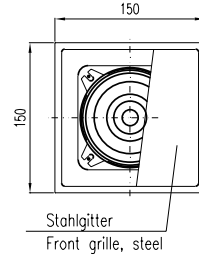

Seitenansicht / Side view

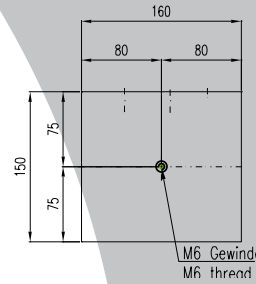

FTS-3

Vorderansicht / Front view

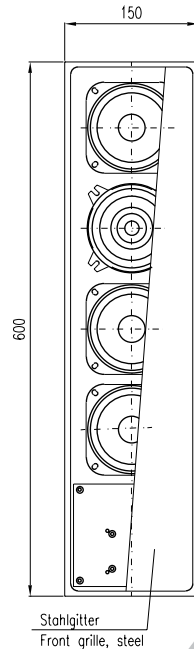

Seitenansicht / Side View

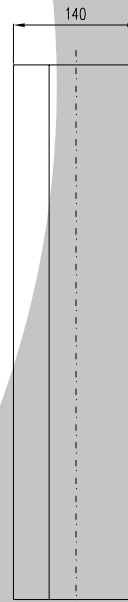

FTS-4

Vorderansicht / Front view

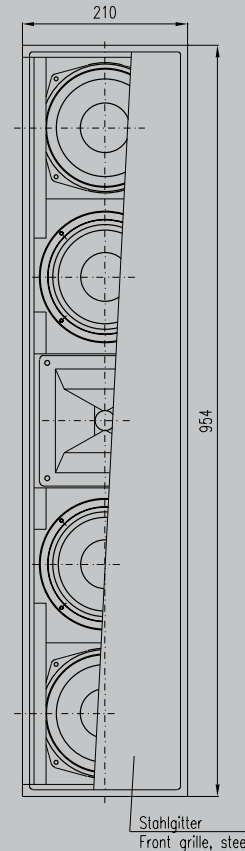

Seitenansicht / Side View

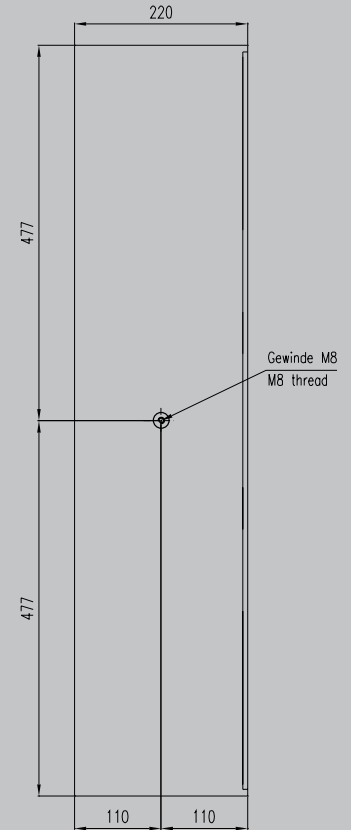

AT-21w

The AT-21w is a weatherproof speaker system specially developed for outdoor applications. Its compact dimensions, excellent power output and outstanding speech intelligibility are impressive.

Technical specifications

Principle	2 way, vented
Power rating (AES/Progr.)	300 W / 400 W
Components	10" / 1" CD, time aligned
Sensitivity	100 dB
SPL max.	127 dB
Frequency response (-10 dB)	75 Hz - 20 kHz
Frequency response (-3 dB)	80 Hz - 20 kHz
Dispersion (HxV)	60° x 40° / 90° x 40° / 90° x 60°
Impedance	8 ohm
Dimensions (WxHxD)	31 x 52 x 29cm
Weight approx.	16 kg
100V version (optional)	120 W / 240 W
Housing	plastic, weather proof
Colour	black
Frontdesign	acoustic transparent foam
Protective grille	metal
Connectors	4 x Speakon (2 x rear, 2 x bottom)



Description

The tough plastic housing is fitted with impregnated 10"/1 CD high-performance speakers. The speakers are time-aligned and well protected by a robust metal protective grille on the front. A special sound-transparent filter foam lining also provides effective protection against water and dust. In total four speakon sockets are installed in the back and base of the housing. A precision-made crossover with electronic high-frequency protection circuit is also integrated. The inside of the housing is reinforced throughout with metal brackets and equipped with 8 M8 threaded inserts for safe installation.

Applications

Sound production in open or damp environments such as sports arenas, stadiums, ski huts, etc.



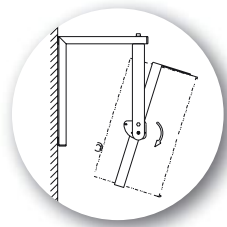

Wall bracket (optional)
TÜV/GS-certified.

- **WAT-21w** Wall bracket, horizontal and vertical adjustment, weatherproof

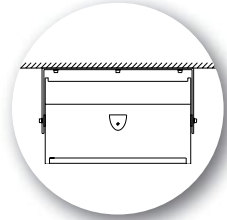

- **VAT-21w** Vertical bracket, metal, weatherproof

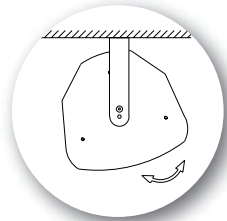

- **QAT-21w** Horizontal bracket, metal, weatherproof



Vorderansicht / Front view

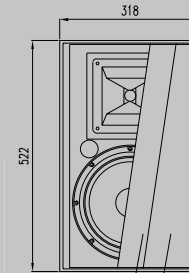

Stahlgitter
Front grille, steel

Seitenansicht / Side view

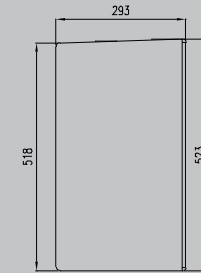

Akustikschaum, anthrazit
Front foam, black

Rückansicht / Rear view

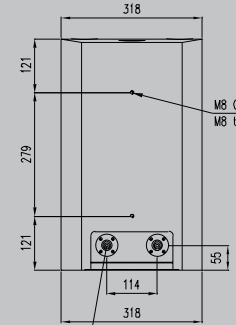

Anschlußfeld Speakon
Speakon connectors

M8 Gewinde
M8 thread

Draufsicht / Top view

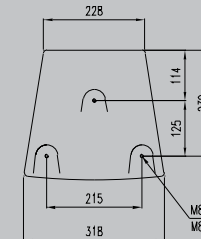

Bodensicht / Bottom view

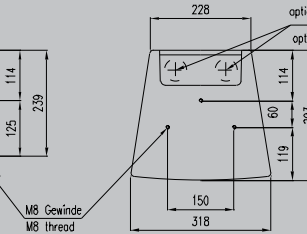

optionale Anschlüsse unten für Speakon
optional Speakon connectors on bottom

M8 Gewinde
M8 thread



VarioTube CS-08 / CS-08sub "in-ceiling"

The CS-08 "in-ceiling" is a real problem solver for fixed installations where a speaker system of high quality needs to be integrated in the ceiling or wall while at the same time satisfying high demands for sound quality, speech intelligibility and dispersion. The hornloaded 2-way coaxial speaker system is capable of producing high sound pressure levels and outstanding speech intelligibility, even at locations with high ceilings. The CS-08 can be mounted quickly, easily and securely. Also available as subwoofer system CS-08sub.

Technical specifications	Fullrange / Mid-High System VarioTube CS-08 "in-ceiling"	Subwoofer System VarioTube CS-08sub "in-ceiling"
	coaxial, hornloaded speaker design even dispersion, conical 90°	8"-Subwoofer, intergral passive crossover (150Hz/12dB/okt.)
Principle	2-way, vented	vented design
Power rating (AES/Progr.)	150 W / 300 W	200 W / 400 W
Components	8"/1" horn loaded	8"
Sensitivity	96 dB	90 dB
SPL max.	126 dB	117 dB
Frequency response (-10dB)	55 Hz - 20 kHz	40 Hz - 150 Hz
Frequency response (-3dB)	65 Hz - 18 kHz	50 Hz - 150 Hz
Dispersion	90° conical	-
Impedance	8 Ohm	8 Ohm
Cover grille dimensions (ø)	38 cm	38 cm
Installation depth	29.5 cm	29.5 cm
Ceiling recess (ø)	36 cm	36 cm
Weight approx.	7 kg without transformer	7 kg without transformer
100 V version (optional)	60 W / 120 W	60 W / 120 W
Colour	black; front white	black, front white
Optional colours	all RAL colours	all RAL colours
Frontdesign	decorative grille, metal	decorative grille, metal
Connectors	Terminal block, 8 pole, front- and rearside	Terminal block, 8 pole, front- and rearside



Typical applications include multi-functional conference halls, trade fair halls, shopping malls, foyers, pubs, restaurants, side rooms in discos/clubs, and much more.



CS-08/CS-08sub "in-ceiling" mounting options

Ceiling/ wall installation

Infinitely adjustable threaded rods ensure convenient ceiling/wall installation. The threaded rod is screwed into the insert on the speaker and into the ceiling (rawplug). The CS-08 can also be secured with optional ring lugs and safety cables.

Suspended ceilings

Easy installation in suspended ceilings via folding metal ceiling mounts attached to the CS-08/CS-08sub. The top of the CS-08 can be adjusted accurately in relation to the ceiling via a sliding mechanism. The CS-08 also be secured with optional ring lugs and safety cables.

The CS-08/CS-08sub are available either with threaded rods or folding metal ceiling mounts.



Ansicht v. unten / Bottom view

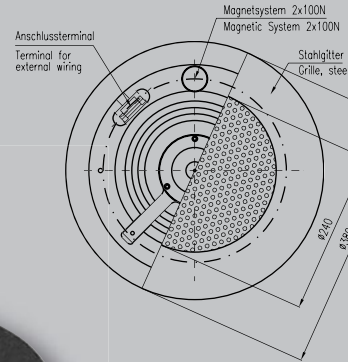

Draufsicht / Top view

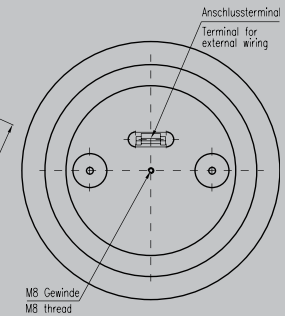

Seitenansicht / Side View

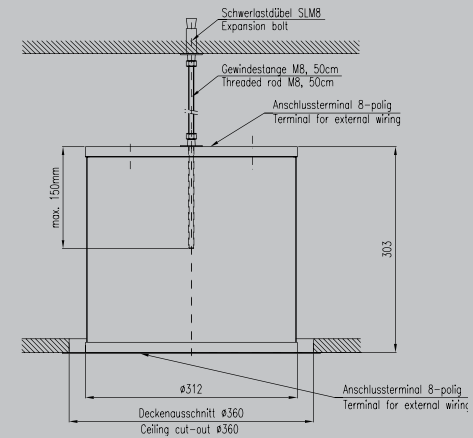

VarioTube CS-08 / CS-08sub "free"

The Fohhn® CS-08 "free" is a powerful, hornloaded 2-way coaxial speaker system that can be used for flying installations or mounted via a bracket. It was designed for applications where in-ceiling and wall mounting is impossible. The outstanding sound quality, excellent speech intelligibility and even dispersion of the CS-08 "free" are very impressive. The CS-08 "free" can be installed quickly, easily and securely. Also available as subwoofer system CS-08sub.

Technical specifications	Fullrange/Mid-High System VarioTube CS-08 "free"	Subwoofer System VarioTube CS-08sub "free"
	coaxial, hornloaded speaker design, even dispersion, conical 90°	8"-Subwoofer, intergral passive crossover (150Hz/12dB/okt.)
Principle	2-way, vented	vented design
Power rating (AES/Progr.)	150 W / 300 W	200 W / 400 W
Components	8" / 1" horn loaded	8"
Sensitivity	96 dB	90 dB
SPL max.	126 dB	117 dB
Frequency response (-10dB)	55 Hz - 20 kHz	40 Hz - 150 Hz
Frequency response (-3dB)	65 Hz - 18 kHz	50 Hz - 150 Hz
Dispersion	90° conical	-
Impedance	8 Ohm	8 Ohm
Dimensions (L x Ø)	36 x 31,5 cm	36 x 31,5 cm
Weight approx.	7.5 kg without transformer	7.5 kg without transformer
100V version (optional)	60 W / 120 W	60 W / 120 W
Colour	white	white
Optional colours	all RAL-colours	all RAL-colours
Frontdesign	acoustic foam	acoustic foam
Connectors	Terminal block, 8 pole, rearside	Terminal block, 8 pole, rearside



Typical applications include trade fair halls, conference rooms, churches, shopping centres, foyers, pubs, restaurants and much more.

CS-08/CS-08sub "free" mounting options

Flying application

Ring lugs and safety wires (optional) ensure easy, secure installation. Two M8 threaded inserts for attaching ring lugs are integrated in the top of the speaker as standard.

Mounting with VHT-08 bracket

Two M8 threaded inserts for attaching the VHT-08 metal bracket quickly and securely are integrated on either side of the CS-08 "free".



Ansicht v. unten / Bottom view

Draufsicht / Top view

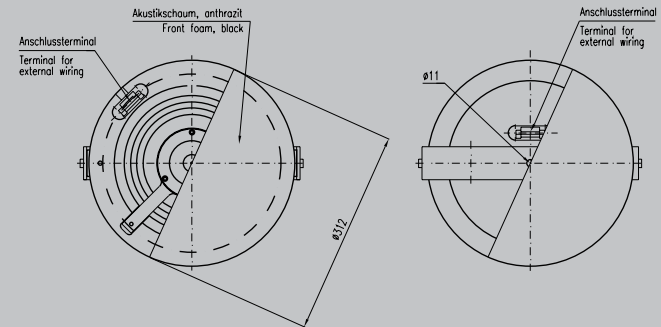

Seitenansicht / Side View

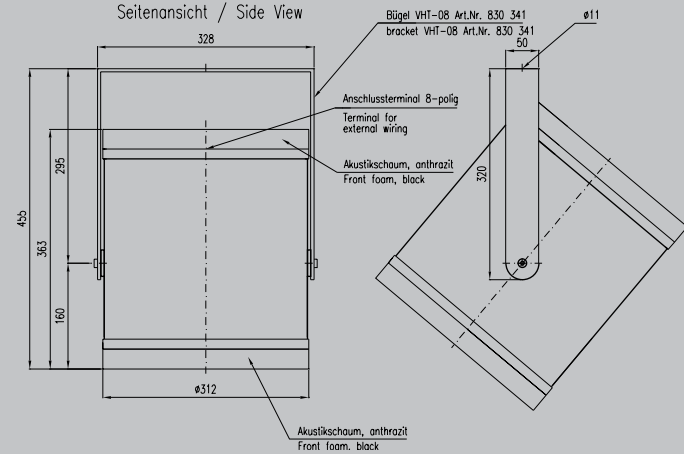



Airport Munich, Germany



Airport Tel Aviv, Israel



Trier Arena, Germany



Jeonju Worldcup Stadium, Korea



Kremlin Palace Hotel, Turkey



Legoland Arena, Germany

References with Fohhn® speaker systems

Airports, stadiums, arenas and theme parks

Airport Munich, Germany

Airport Tel Aviv, Israel

Jeonju Worldcup Stadium, Korea

Skiing Sports Stadium Oberstdorf, Germany

Stadium Bern, Switzerland

Stadium De Arena, (VIP-lounges)

Amsterdam, Netherlands

Stadium SSV Reutlingen, Germany

Sports Stadium Idar Oberstein, Germany

Ice Sports Stadium, Lustenau / Österreich

Trier Arena, Germany

Horse Riding and Sports Arena (indoor & outdoor),
Kreuth, Germany

Legoland Arena, Günzburg, Germany

Ouwehands Dierenpark, Rhenen, Netherlands

De Nederlandse Spoorwegen, Netherlands

Conference- and Presentation Centres

Kremlin Palace, Moscow, Russia

Conference & Media Centre of the President
of Saxon, Dresden, Germany

DaimlerChrysler, Presentation & Training Centre,
Wiesensteig, Germany

VW, Volkswagen Conference Centre R&D,
Wolfsburg, Germany

Mc Laren Presentation Centre, London, England

Bosch Conference Centre, Kista, Sweden

AMG, Präsentationscenter, Leinfelden, Germany

Nordurorka Powerplant, Akureyri, Island

Saxon State Ministry, Press Centre,
Dresden, Germany

Technical University, Graz, Austria

German Telecom, Stuttgart, Germany

Mercedes Benz Presentation Centre, Berlin,
Munich, Germany

House of Sports, Stuttgart, Germany



Kremlin Palace, Moskau



Mercedes Benz Presentation Centre, Berlin



Press Centre, Dresden, Germany



Skiing Stadium, Oberstdorf, Germany

Theatres and Concert Halls

Herzlia Art Performance Center, Israel

Theatre Wilhelmshöhe, Lingen, Germany

Park Theatre, Bensheim, Germany

Schleißwigholsteinisches Landestheater, Germany

Schubert Theatre, Feldkirch, Austria

Bregenzer Festspiele, Bregenz, Austria

Theatro di Brez, Merano, Italy

Concert hall, Heidenheim, Germany

Staatstheater Stuttgart/ Chamber Theatre,
Stuttgart, Germany

Museums & Castles

Yad Vachem, Israel

Museum of Arts, Wolfsburg, Germany

Atlantis Museum, Duisburg, Germany

Ben Gurion Heritage Museum, Israel

Museum Offenbach, Germany

Castle of Saarbrücken, Germany

Castle of Heimsheim, Germany



Skiing Stadium, Oberstdorf, Germany

Stiftskirche, Stuttgart, Germany



Trier Arena, Germany



Swimming Park, Nürtingen, Germany



Ketilhusid Hall, Akureyri, Iceland



Stadium, Reutlingen, Germany

Broadcast

ARD Hauptstadtstudio, Berlin, Germany

Deutschlandradio Kultur, Berlin, Germany

Radio Ton, Heilbronn, Germany

Radio 7, Ulm, Germany

SWR, Baden-Baden, Germany

Ruhrsporthalle, Mülheim an der Ruhr

Congreß & Town Hall of Bonn, Germany

Sports Hall Echterdingen, Germany

Conference & Music Hall Leonberg, Germany

Sports Hall, Heddesheim, Germany

Sporthall Spergau, Germany

Town Hall Neunkirchen, Germany

Neustadthalle Saxon, Germany

Exhibition Centres, Sports Halls and Town Halls

Exhibition Centre Nuremberg, Germany

Congress & Exhibition Centre Innsbruck, Austria

Ketilhusid Hall, Akureyri, Island

Cruise Ships

Cruise Ship Aida Blue

Cruise Ship Albatros

Stiftskirche, Stuttgart



Club Suite 212, Stuttgart*



Theater an der Wilhelmshöhe, Lingen



* Architekten: Bottela + Ehrhardt, Bild: Alexander Fischer



Uditorium, Germany



University, Tübingen, Germany



Historical Church, Germany



K3N, Nürtingen, Germany



Maritim Hotel, Magdeburg, Germany



Mc Laren, Presentation Centre, London

Universities

Dong Woo University, Seoul, Korea

Jin-Joo University, Seoul, Korea

Vrije Universiteit, Amsterdam, Netherlands

Universiteit, Leiden, Netherlands

Universiteit Utrecht, Netherlands

University of Tübingen, Germany

University of Koblenz, Germany

University of Dresden, Germany

Offiziershochschule Dresden, Germany

Fraunhoferinstitut, Dortmund, Germany

Fraunhoferinstitut Stuttgart, Germany

Banks

Deutsche Bank, Berlin, Germany

Allianz Versicherungen, Solingen, Germany

Gerling Cologne, Germany

Rabobank Uithoorn, Niederlande, Germany

Landesgirokasse, Ulm, Germany

Sparkasse Lindau, Germany

Bezirkssparkasse Weinheim, Germany

Sparkasse Speyer-Otterstadt, Germany

Volksbank Kamen-Werne, Germany

Volksbank, Hochrhein, Germany

Oldenburgische Landesbank, Germany

Clubs and Discos

Club Atlantis, Basel, Schweiz

Blue Lagune, Zürich, Schweiz

Club Suite 212, Stuttgart, Germany

Club Colibri, Stuttgart, Germany

Club Barcode, Stuttgart, Germany

Berdema Club, Nicosia, Cyprus

Hamlet Club, Limassol, Cyprus

Leyla Club, Istanbul, Turkey

Seurahuone Night club " Night ",
Sokos Hotel Lahden, Finland

Night Club Ilves and Bar Amarillo,
Sokos Hotel Ilves, Finland

Unterhaus, Mainz, Germany

Alter Schlachthof, Geislingen, Germany

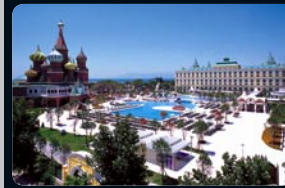

Kremlin Palace Hotel, Antalya, Turkey



Cruise Ship Aida



World Palace Hotel, Turkey



Horse Riding Arena, Kreuth

Hotels

Hilton Hotel, Helsinki, Finland

WOW Hotel, Kremlin Palace, Antalya, Turkey

WOW Hotel, Bodrum Resort, Bodrum, Turkey

WOW Hotel, Topkapi Palas, Antalya, Turkey

Sokos Hotel Vantaa danceraestaurant
Tulisuudelma, Finland

TUI Family Resort Hotel, Werfenweng, Austria

Maritim Hotel, Magdeburg, Halle,
Timmendorfer Strand, Germany

Hotel Adlon, Berlin, Germany

Churches

Stiftskirche, Stuttgart, Germany

Kath. Kirche St. Wolfgang, Regensburg, Germany

Kath. Kirche St. Martin, Ried im Innkreis - Austria

Kath. Kirche St. Martin, Schwarzach, Germany

Kath. Kirche St. Michael in Steinach, Germany

Evangelische Kirche Romanshorn, Switzerland

Evangelische Kirche Weinfelden, Switzerland

Grosse Kirche Fluntern, Zürich, Switzerland

Croyden Church, London, England

St. Cathrins Church, Dublin, Ireland

Evangelische Kirche Judenburg, Austria

Stadtkirche Merano, Italy

Stadtkirche, Freudenstadt, Germany

Stadtkirche, Trier, Germany

BGG, Kirchentellinsfurt, Germany

Baptist Church, Reutlingen, Germany

Pentecostal Church, Kirchheim, Germany

Evang. Stadtkirche, Nürtingen, Germany

Methodist Church, Marbach, Germany

St. Wolfgang's Church, Regensburg



WOW Football Stadium



UO Skiing Hotel, Finland



Technical specifications

	AT-05	AT-06	AT-07	AT-08	AT-09
Principle	2 way, vented	2 way, vented	2 way, vented	2 way, closed	2 way, closed
Power rating (AES/Progr.)	80 W / 120 W	100 W / 200 W	150 W / 300 W	150 W / 300 W	200 W / 400 W
Components	1 x 5"/1" short horn time-aligned	6"/1" short horn time-aligned	6.5"/1" CD/ time-aligned	2 x 6"/1" short horn time-aligned	2 x 6.5"/1" CD time-aligned
Sensitivity	88 dB	90 dB	96 dB	95 dB	98 dB
SPL max.	108 dB	113 dB	123 dB	119 dB	125 dB
Frequency response (-10 dB)	60 Hz - 20 kHz	45 Hz - 20 kHz	65 Hz - 20 kHz	50 Hz - 20 kHz	65 Hz - 20 kHz
Frequency response (-3 dB)	80 Hz - 19 kHz	60 Hz - 20 kHz	85 Hz - 20 kHz	65 Hz - 20 kHz	75 Hz - 20 kHz
Dispersion (HxV)	90° x 90°	90° x 90°	90° x 60°	90° x 40°	90° x 60°
Impedance	8 ohm	8 ohm	16 ohm	8 ohm	8 ohm
Dimensions (WxHxD)	16.5 x 28.5 x 20 cm	19.5 x 38 x 23 cm	19.5 x 38 x 23 cm	19.5 x 51 x 23 cm	19.5 x 51 x 23 cm
Weight approx.	4.5 kg	5.5 kg	7.3 kg	7 kg	10.5 kg
100V version (optional)	25 W	60 W / 120 W	60 W / 120 W	60 W / 120 W	60 W / 120 W
Housing	MDF	Multiply birchwood	Multiply birchwood	Multiply birchwood	Multiply birchwood
Colour	black, white	black, white	black, white	black, white	black, white
Optional colours	all RAL-colours	all RAL-colours	all RAL-colours	all RAL-colours	all RAL-colours
Piano finishing	optional	optional	optional	--	--
Weather proof coating	--	optional	optional	optional	optional
Weather proof housing	--	--	--	--	--
Frontdesign	acoustic transparent foam	acoustic transparent foam	acoustic transparent foam	acoustic transparent foam	acoustic transparent foam
Protective grille	metal	metal	metal	metal	metal
Connectors	terminals	Speakon + 4-point terminal plug (inside)	Speakon + 4-point terminal plug (inside)	Speakon + 4-point terminal plug (inside)	Speakon + 4-point terminal plug (inside)

AT-20	AT-30	AT-35	AT-40	AT-50	AT-21w
2 way, vented	2 way, vented	2 way, vented	2 way, vented	2 way, vented	2 way, vented
300 W / 600 W	350 W / 700 W	500 W / 900 W	500 W / 1000 W	500 W / 1000 W	300 W / 400 W
10" / 1" CD time-aligned	12" / 1" CD time-aligned	12" / 1" CD, neodym time-aligned	12" / 1.4" CD, neodym time-aligned	15" / 1.4" CD, neodym time-aligned	10" / 1" CD time aligned
101 dB	97 dB	100 dB	100 dB	100 dB	100 dB
129 dB	127 dB	131 dB	134 dB	134 dB	127 dB
65 Hz - 20 kHz	55 Hz - 20 kHz	55 Hz - 20 kHz	50 Hz - 20 kHz	45 Hz - 20 kHz	75 Hz - 20 kHz
75 Hz - 20 kHz	65 Hz - 20 kHz	65 Hz - 20 kHz	60 Hz - 20 kHz	55 Hz - 20 kHz	80 Hz - 20 kHz
60° x 40° / 90° x 40° / 90° x 60°	60° x 40° / 90° x 40° / 90° x 60°	60° x 40° / 90° x 40° / 90° x 60°	60° x 40° / 80° x 50°	60° x 40° / 80° x 50°	60° x 40° / 90° x 40° / 90° x 60°
8 ohm	8 ohm	8 ohm	8 ohm	8 ohm	8 ohm
33 x 51 x 30 cm	38 x 59 x 42 cm	38 x 59 x 42 cm	38 x 59 x 42 cm	46 x 68 x 46.5 cm	31 x 52 x 29cm
15,5 kg	20 kg	19 kg	22 kg	28 kg	16 kg
120 W / 240 W	120 W / 240 W	120 W / 240 W / 360 W	120 W / 240 W / 360 W	120 W / 240 W / 360 W	120 W / 240 W
Multiply birchwood	Multiply birchwood	Multiply birchwood	Multiply birchwood	Multiply birchwood	plastic, weather proof
black, white	black, white	black, white	black, white	black, white	black
all RAL-colours	all RAL-colours	all RAL-colours	all RAL-colours	all RAL-colours	
--	--	--	--	--	--
optional	optional	optional	optional	optional	optional
optional	optional	optional	optional	optional	yes
acoustic transparent foam	acoustic transparent foam	acoustic transparent foam	acoustic transparent foam	acoustic transparent foam	acoustic transparent foam
metal	metal	metal	metal	metal	metal
Speakon + 4-point terminal plug <small>(inside)</small>	Speakon + 4-point terminal plug <small>(inside)</small>	Speakon + 4-point terminal plug <small>(inside)</small>	Speakon + 4-point terminal plug <small>(inside)</small>	Speakon + 4-point terminal plug <small>(inside)</small>	4 x Speakon <small>(2 x rear, 2 x bottom)</small>



Architectural Sound Design.



Sound . Innovation . Design .

The new Fohhn® ARC series – a well conceptualized speaker and accessory system for high quality fix installations.





Dealer adress:

Fohhn Audio AG

Hohes Gestade 3-5 • D-72622 Nürtingen • Germany

Tel. +49 7022 93323-0 • Fax +49 7022 93324-0

info@fohhn.com • www.fohhn.com

Design, features and supply are subject to change. © by Fohhn®